

SERIES 1060 | IN-LINE CIRCULATORS

1.5D AND 2D | SUBMITTAL

File No: 10.54
 Date: OCTOBER 07, 2013
 Supersedes: 10.54
 Date: APRIL 15, 2008

Job: _____ Representative: _____
 _____ Order no.: _____ Date: _____
 Engineer: _____ Submitted by: _____ Date: _____
 Contractor: _____ Approved by: _____ Date: _____

PUMP DESIGN DATA

Pump model: _____ Flange size: _____
 No. of pumps: _____ Note: _____
 Capacity: _____ USgpm (L/s) Temperature: _____ °F (°C)
 Head: _____ ft (m) Liquid: _____
 Companion flanges: _____ Included: _____

MAXIMUM PUMP OPERATING CONDITIONS

175 psig at 225°F (1208 kPa at 107°C)

OPTIONAL EQUIPMENT

MOTOR DESIGN DATA

HP: _____ kW: _____ RPM: 1750
 Frame size: _____ Enclosure: _____
 Volts: _____ Hertz: _____ Phase: _____

MATERIALS OF CONSTRUCTION

PART NAME	BRONZE FITTED	LEAD FREE BRONZE
Pump body	Cast iron	Lead free bronze
Impeller	Bronze	Lead free bronze

Bearings: Sleeve-oil lubricated **Seal:** Mechanical
Shaft: Alloy steel-copper sleeve **Motor:** 1800 RPM
Stationary seal face: ARMSEAL ceramic SINGLE OR THREE PHASE THRU 1 HP - resilient mount
Coupler: Flexible, spacer type SINGLE OR THREE PHASE 1.5 HP - rigid mount
 THREE PHASE 2 HP AND ABOVE- rigid mount

PUMP BODY DIMENSIONS

PUMP SIZE	FLANGE SIZE	DIMENSIONS INCHES (mm)				
		B	D	E	F	H
1.5D	1.5	13.50 (343)	0.88 (22)	1.00 (25)	4.63 (117)	4.88 (124)
2D	2	14.00 (356)	0.88 (22)	1.00 (25)	4.75 (121)	5.13 (130)

PUMP AND MOTOR DATA

PUMP SIZE	MOTOR HP	DIMENSIONS INCHES (mm)						SHIPPING WEIGHT lbs (kg)
		RESILIENT MOUNT			RIGID MOUNT			
		A	C	K	L	M	N	
1.5D	0.5	22.00 (559)	18.75 (476)	9.88 (251)	-	-	-	86 (39.0)
	0.75	23.00 (584)	19.75 (502)	10.38 (264)	-	-	-	82 (37.2)
	1	23.50 (597)	20.25 (514)	10.88 (276)	-	-	-	92 (41.7)
	1.5	-	-	-	21.50 (546)	18.25 (464)	8.88 (225)	115 (52.2)
2D	0.5	22.75 (578)	19.25 (489)	9.88 (251)	-	-	-	90 (40.8)
	0.75	23.75 (603)	19.75 (502)	10.38 (264)	-	-	-	96 (43.5)
	1	23.75 (603)	20.25 (514)	10.88 (276)	-	-	-	100 (45.4)
	1.5	-	-	-	21.75 (552)	18.25 (464)	8.88 (225)	120 (54.4)
	2	-	-	-	22.75 (578)	19.25 (489)	9.88 (251)	124 (56.2)

NOTE:

- Dimensions shown are for reference only.
- Rotation viewed from motor end is clockwise.
- Tapped openings are provided in the pump body for venting and gauge connections.

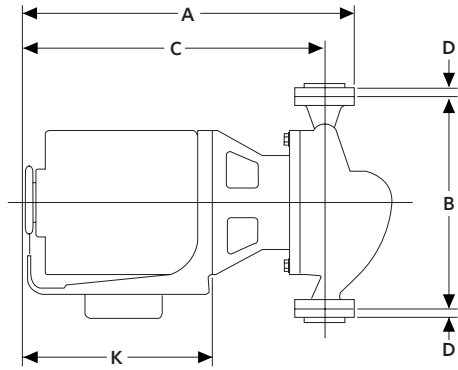

RESILIENT MOUNT

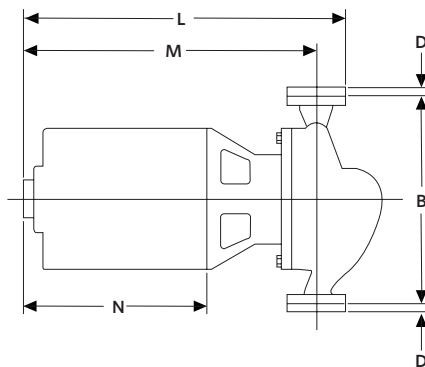

RIGID MOUNT

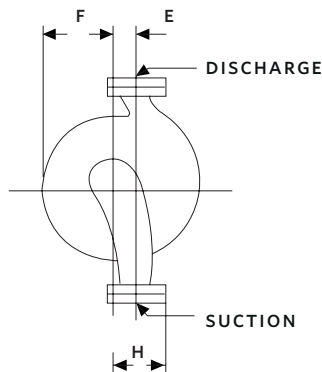

SERIES 1060 PERFORMANCE CURVES

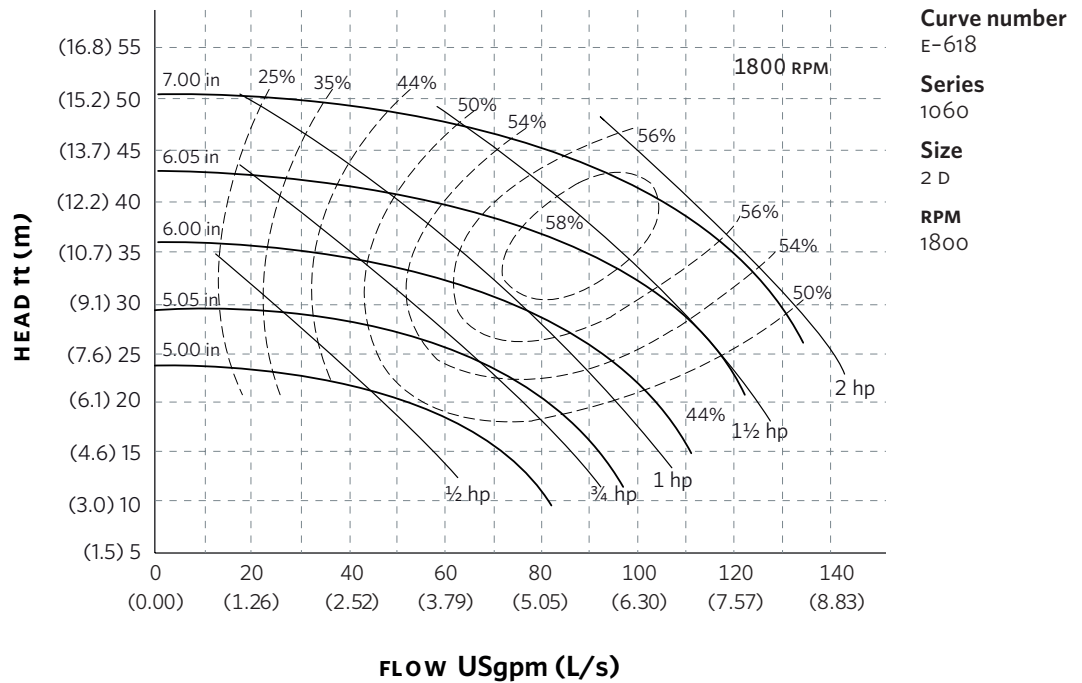
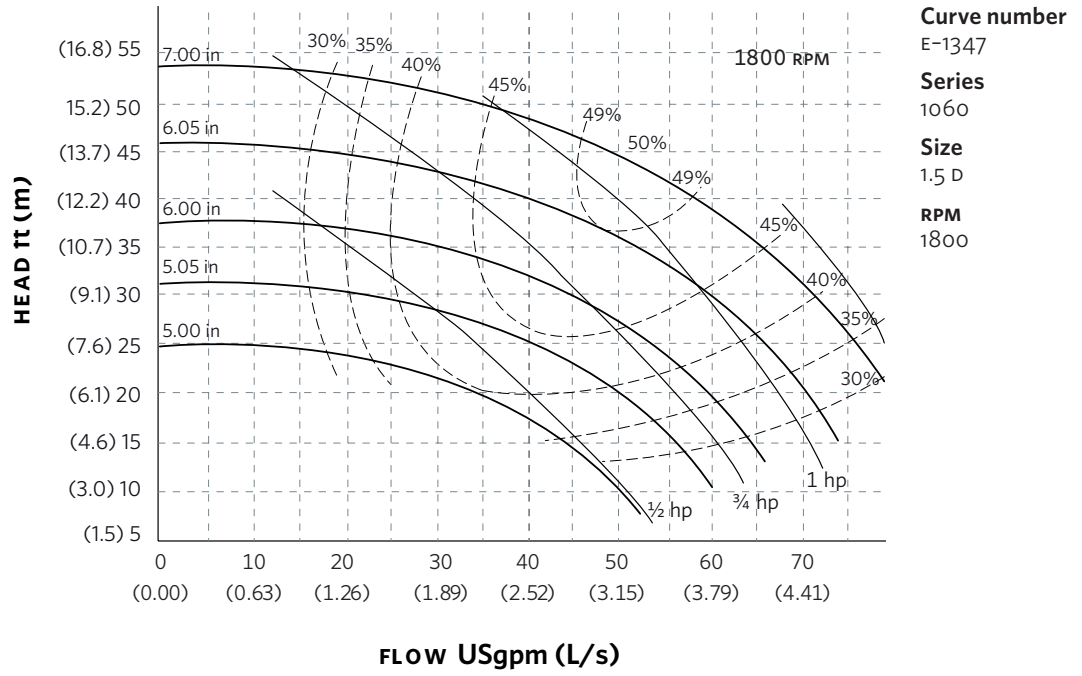

Performance curves are for reference only.
Confirm current performance data with Armstrong ACE ONLINE selection software.

TORONTO

23 BERTRAND AVENUE
TORONTO, ONTARIO
CANADA
M1L 2P3
+1 416 755 2291

BUFFALO

93 EAST AVENUE
NORTH TONAWANDA, NEW YORK
U.S.A.
14120-6594
+1 716 693 8813

BIRMINGHAM

HEYWOOD WHARF, MUCKLOW HILL
HALESOWEN, WEST MIDLANDS
UNITED KINGDOM
B62 8DJ
+44 (0) 8444 145 145

MANCHESTER

WENLOCK WAY
MANCHESTER
UNITED KINGDOM
M12 5JL
+44 (0) 8444 145 145

BANGALORE

#59, FIRST FLOOR, 3RD MAIN
MARGOSA ROAD, MALLESWARAM
BANGALORE, INDIA
560 003
+91 (0) 80 4906 3555

SHANGHAI

NO. 1619 HU HANG ROAD, XI DU TOWNSHIP
FENG XIAN DISTRICT, SHANGHAI
P.R.C.
201401
+86 21 3756 6696

**MAKING
ENERGY
MAKE
SENSE™**